



O'M Engineering Inc.  
[www.omengineering.ca](http://www.omengineering.ca)

# 2024 CORPORATE PROFILE



# ABOUT O'M ENGINEERING

**Where innovation sparks, trends are set, and electrical engineering reaches new heights!**

Founded in 2019, we are a dynamic force with over six decades of combined experience, pushing the boundaries of what's possible in the realm of electrical engineering.

We are not just engineers; we're visionaries, crafting logical, cost-effective, and brilliantly efficient solutions that redefine industry standards. We don't just follow trends; we create them.

We are your go-to experts in a wide array of sectors, including residential, educational, commercial, healthcare, recreational, indigenous, and transit projects. Our versatility knows no bounds, and our innovative spirit thrives in every sector we touch.

At O'M Engineering, we don't just engineer; we electrify possibilities!



## OUR EXPERTISE

At O'M Engineering, our commitment to excellence, innovation, and sustainability is at the cornerstone of everything we do. With a proven track record and a team of seasoned electrical engineers, we bring a wealth of experience and knowledge to the forefront of the industry

Since its inception, O'M Engineering has embarked on a journey of excellence, collaborating on more than 900 projects throughout the beautiful British Columbia. Our dedicated team comprises of individuals with distinct areas of expertise, which converges together to fuel our passion for delivering outstanding project results.

Coming from all corners of the world, our team members have a rich tapestry of global experience and collective wisdom which consistently culminates in the achievement of exceptional results, time and time again.



## ABOUT OUR BRAND

### O'M

The ohm ( $\Omega$ ) is the unit of measure of electrical resistance.

Resistance is the aspect of an electrical system that makes it possible to see, hear and feel the effects of electricity.

The creative power of electricity is captured in our logo in the form of the light bulb which has become, since Thomas Edison's eureka moment in 1879, the universal symbol for inspiration.

## OUR PRINCIPALS

O'M will ensure owner involvement in all of our projects from inception to completion and we're not afraid to roll up our sleeves and get our hands dirty.

## OUR BRAND ESSENCE

### POTENTIAL

Energy flows through a system when there is a difference of potential.

While resistance in the system stems flow, it makes energy seen, heard and felt.

O'M seeks to drive progress by enhancing this balance.



## OUR PEOPLE

Our team, is both perfectionistic and experienced. We value relevant academic qualifications combined with tenacity and a healthy amount of EQ.

## OUR BRAND VALUES

### PROGRESS

Progress should not come at the cost of sustainability.

True progress should not simply be expressed, but it should be felt.

We believe that the challenge provided by resistance is what allows us to progress.



### FLOW

Flow (being in the zone) is the mental state in which a person is fully immersed in and completely absorbed in a process. Flow makes inspired results possible.

We value flow in our work and in the end user's experience of the systems that we create.



### NEVER GIVE UP

Tenacity (specific strength) is a material's strength-to-weight ratio.

O'M demonstrates a remarkable strength-to-weight by performing at a standard that belies its scale because we never give up.





## OUR SERVICES

O'M Engineering is a premier provider of comprehensive electrical and electronic engineering solutions tailored to numerous commercial sectors. Our offerings encompass an array of critical services, including power distribution, innovative lighting and lighting controls, state-of-the-art fire alarm systems, emergency lighting solutions, code compliant exit signage, communications systems, security solutions, integrated audio-visual systems, and seamless connections to mechanical equipment. With a commitment to excellence, we ensure that businesses across various industries receive top-notch electrical engineering support for their unique requirements.

### General Services:

- Power distribution
- Lighting and lighting controls
  - Fire alarm Systems
  - Emergency Lighting
    - Exit Signage
- Communications Systems
  - Security Systems
- Audio Visual Systems
- Connections to Mechanical Equipment

### Other Services:

- Design Reviews
- Warranty Reviews
- Condition Assessments
- Code Compliance Consultation
- Due Diligence Reports
- Project Management

## SUSTAINABILITY

In every project we undertake, the integration of energy-efficient technologies, renewable energy solutions, and environmentally friendly materials is central to our designs. Our commitment to sustainable building practices is highlighted by our team of LEED accredited professionals. Each team member is well-versed in ASHRAE standards, BC Hydro Energy Efficiency specifications, Photovoltaic designs, SolarEdge technology, and the intricacies of NetZero building principles. Furthermore, our team is well-equipped to undertake projects that demand adherence to Passive House standards, comply with LEED Gold specifications, and meet various Step Code Levels.



**PHOTOVOLTAICS**



**LEED®**



**NETZERO**



**EVSE SOLUTIONS**

# MARKET SECTORS

Residential  
Transportation  
Commercial

Education  
Healthcare  
Indigenous

Civic / Cultural  
Light Industrial  
Tenant Improvements

Data Centres  
Recreational  
Hospitality & Retail

# OUR CLIENTS INCLUDE

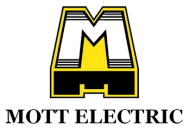
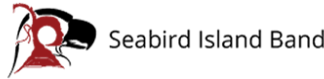



# OUR TEAM



# RESIDENTIAL



## AEGEAN HOMES

### Overview:

The design and construction of a four-storey, timber-framed, mixed-use, multi-family residential development.

### Size:

3,054 m<sup>2</sup>

### Client:

Anxin Projects

### Status:

In construction



## ALICE SAUNDERS AFFORDABLE HOUSING

### Overview:

The design and construction of 146 units of social housing for seniors.

### Size:

9,000 m<sup>2</sup>

### Client:

Brightside Community Homes

### Status:

In construction



## WEST 28TH + WILLOW

### Overview:

Four levels, with a rooftop, this proposed development will consist of 26 stacked townhomes.

### Size:

2,881 m<sup>2</sup>

### Client:

Urbanex Strategies

### Status:

In design



# RESIDENTIAL



## ELEMENTS

### Overview:

The design and construction of a 27-storey building with 195 units.

### Size:

16,251 m<sup>2</sup>

### Client:

Baydo Development Corporation

### Status:

In construction



## TELFORD TOWERS

### Overview:

The design and construction of two towers: one 50-storey mixed-use and one 20-storey rental development.

### Size:

31,918 m<sup>2</sup> & 10,771 m<sup>2</sup>

### Client:

Westland

### Status:

In construction



## HEATHER PLACE

### Overview:

A six storey, wood-framed structure with a mix of studio, one, two, and three-bedroom units.

### Sustainable/Energy Target

Step Code 4

### Client:

BC Housing

### Status:

In construction





# RESIDENTIAL



## PITT MEADOWS

### Overview:

The design and construction of a an affordable rental housing complex with an integrated childcare facility.

### Size:

10,637 m<sup>2</sup>

### Client:

Metro Vancouver Housing Corporation

### Status:

In design



## WELCHER AVENUE

### Overview:

The design and construction of a 4-storey, 50 unit, multi-family, affordable development.

### Size:

4,134 m<sup>2</sup>

### Client:

Metro Vancouver Housing Corporation

### Status:

In construction



## 800 COMMERCIAL DRIVE

### Overview:

Design services for 92 units of community focused and affordable housing.

### Size:

8,361 m<sup>2</sup>

### Client:

VAHA & BC Housing

### Status:

In design



# TRANSPORTATION



## BURRARD SKYTRAIN STATION UPGRADE

### Overview:

The design of the backbone wiring and electrical infrastructure for TransLink's internal systems.

### Client:

TransLink

### Status:

Ongoing

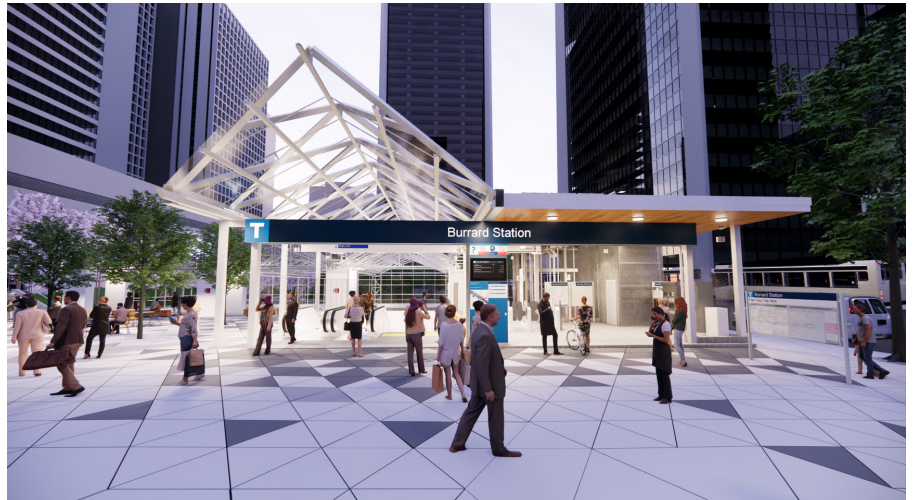

## VICTORIA TRANSIT CENTRE

### Overview:

Design services for the Victoria Regional Transit System's security and facility upgrades.

### Client:

BC Transit

### Status:

Ongoing



## GILMORE STATION UPGRADE

### Overview:

Conceptual design services for the upgrades at Gilmore Station in Burnaby, BC.

### Client:

TransLink

### Status:

Ongoing

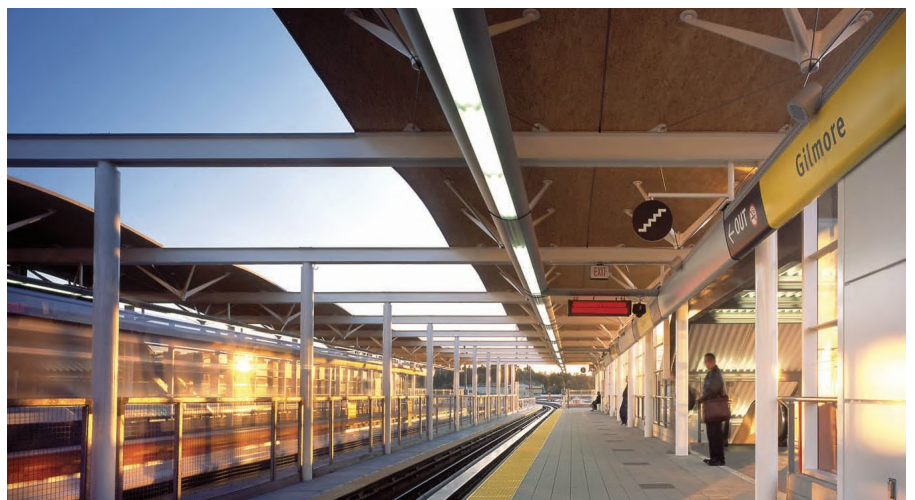

# INDIGENOUS



## TSESHAHT FIRST NATION COMMUNITY HALL

### Overview:

Two-storey building with a full kitchen, storage space, patios, etc.

### Size:

650 m<sup>2</sup>

### Client:

Tseshah First Nation

### Status:

In construction



## OKIB CULTURAL IMMERSION SCHOOL

### Overview:

New school including admin areas, a gym, classrooms, a library, etc.

### Size:

2,347 m<sup>2</sup>

### Client:

Okanagan Indian Band

### Status:

In construction



## TL'AZT'EN NATION MIDDLE RIVER HEALTH CENTRE

### Overview:

Single storey, wood-framed with exam room, first aid room, lobby, etc.

### Size:

227 m<sup>2</sup>

### Client:

Tl'azt'en Nation

### Status:

In design



# EDUCATIONAL



## TA'TALU ELEMENTARY SCHOOL

### Overview:

The design and construction of a new 3-storey elementary school.

### Size:

5,965 m<sup>2</sup>

### Client:

School District No. 36 (Surrey)

### Status:

In construction



## UBC FOOD & BEVERAGE INNOVATION CENTRE

### Overview:

Includes food + beverage processing area, labs, packing area, brewery, etc.

### Size:

766 m<sup>2</sup>

### Client:

UBC Properties Trust

### Status:

In construction



## SFU LIBRARY LIGHTING REDESIGN

### Overview:

The interior renovation of SFU WAC Library 5000 Level.

### Client:

Simon Fraser University

### Status:

In design



# HEALTHCARE



## RICHMOND URGENT & PRIMARY CARE CENTRE

### Overview:

Schematic & detailed design services for Richmond's new UPCC.

### Size:

929 m<sup>2</sup>

### Client:

Vancouver Coastal Health

### Status:

Ongoing



## NOAKES & OUTPATIENTS PEDIATRICS

### Overview:

Relocation of these programs from RGH to a new space at Gilbert Rd.

### Size:

210 m<sup>2</sup>

### Client:

Fraser Health Authority

### Status:

Ongoing



## RICHMOND HOSPITAL - CLINIC RELOCATION

### Overview:

Relocation of the hand clinic from the hospital ground floor to the cast clinic on the ground floor.

### Client:

Vancouver Coastal Health

### Status:

Completed



# CIVIC



## CITY OF VANCOUVER WEST ANNEX RENOVATION

### Overview:

A tenant improvement on the 4th floor of the West Annex Building.

### Size:

929 m<sup>2</sup>

### Client:

City of Vancouver

### Status:

Completed



## RCMP PORT MOODY TENANT IMPROVEMENT

### Overview:

The design of office and laboratory space at the RCMP Port Moody detachment

### Client:

Royal Canadian Mountain Police

### Status:

Ongoing



## CROFTON FIRE HALL RENOVATIONS & ADDITION

### Overview:

Redevelopment of the existing fire hall and addition of a new wing to provide support functions.

### Client:

District of North Cowichan

### Status:

Ongoing



# SUSTAINABILITY



## CARBON ENGINEERING FACILITY

### Overview:

Carbon Engineering's new head office and innovation center.

### Size:

1,233 m<sup>2</sup>

### Client:

Carbon Engineering

### Status:

Completed



## LULULEMON PHOTOVOLTAIC INSTALLATION

### Overview:

Engineer of Record for the newly installed solar array system.

### Size:

2,592 solar panels

### Client:

Shift Energy Group

### Status:

Completed



## GREEN FLEET STRATEGIC PLAN

### Overview:

The development of a GFSP for the City's existing and future fleet-related efforts and operations.

### Client:

City of Coquitlam

### Status:

Ongoing



# RECREATIONAL



## HOLLYBURN COUNTRY CLUB RENEW '22

### Overview:

New kitchen facilities, expansion of interior + exterior space, relocations of admin space, program spaces, etc.

### Client:

Hollyburn Country Club

### Status:

In construction



## CHUCK BAILEY RECREATION CENTRE

### Overview:

The design and construction of the City Centre Sports Complex expansion.

### Size:

4,645 m<sup>2</sup>

### Client:

City of Surrey

### Status:

Ongoing



## PROPHET RIVER ICE RINK

### Overview:

The design and construction of a 3/4 NHL sized rink within an exterior, covered building.

### Client:

Prophet River First Nation

### Status:

Completed





# EV CHARGING



## BCRTC OMCI - EV CHARGERS

### Overview:

The installation of chargers at the Skytrain Operations & Maintenance Centre 1 (OMCI).

### Client:

British Columbia Rapid Transit Company (BCRTC)

### Status:

Ongoing



## SURREY CITY HALL STAFF & FLEET EV

### Overview:

The design and installation of new chargers, wheel stops, and circuits for staff and fleet.

### Client:

City of Surrey

### Status:

Ongoing



## VCH - EV CHARGERS DESIGN SERVICES

### Overview:

The design services for EV charging stalls at six Vancouver Coastal Health locations.

### Client:

Vancouver Coastal Health

### Status:

Completed





O'M Engineering Inc.  
www.omengineering.ca



omengineering.ca



(236) 521 6900 & (778) 628 2550



info@omengineering.ca



O'M Engineering



@omengineering\_van